

## Data Sheet

<b>Type Number</b>	55115
<b>Designation IEC System</b>	HR 15 / 49 NiMH
<b>UL Recognition</b>	MH13654
<b>Nominal Voltage</b>	1.2 V
<b>Rated Capacity (0.2 C / 1.0 V)</b>	1300 mAh

**Impedance AC at 1 kHz, fully charged** < 38 mOhm

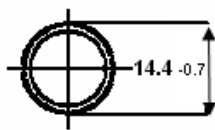

**Typical Capacity at 0.2 C / 1.00 V** 1340 mAh

**Max Discharge Current (cont. / 1.0 V)** 3900 mA

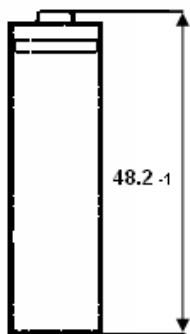
**Dimensions**

Diameter (a)	14.4 $-_{0.7}$ mm
Height (b)	48.2 $-_{1.0}$ mm
Cap Diameter (d)	6.5 mm
Weight, approx	25 g

**Charge Conditions**

Standard Charge	130 mA / 16 h ( $t_{max}$ )
Fast Charge (charge termination control recommended).	650 mA to 1300 mA (0.5 to 1 C)
Control parameters	- $\Delta U$ = 0 – 5 mV DT / dt = 0.8 °C / min (0.5 to 0.9 C) 0.8 °C – 1 °C / min (1 C) Temp. cut-off = 45 – 50 °C Timer: 105 % nominal input
Trickle Charge (0.05 - 0.1 C)	65 - 130 mA

**Temperature Range**

Storage 1 Year <sup>(1)</sup>	-20 °C - +25 °C
6 Month	-20 °C - +35 °C
1 Month	-20 °C - +45 °C
<sup>(1)</sup> recharge every 6 months	
Charge	0 °C - 45 °C
Fast Charge	10 °C - 45 °C
Discharge	-20 °C - 50 °C

All Data contained herein is for single cells  
For battery applications, performance data may vary from single cell data, depending on specific battery configuration